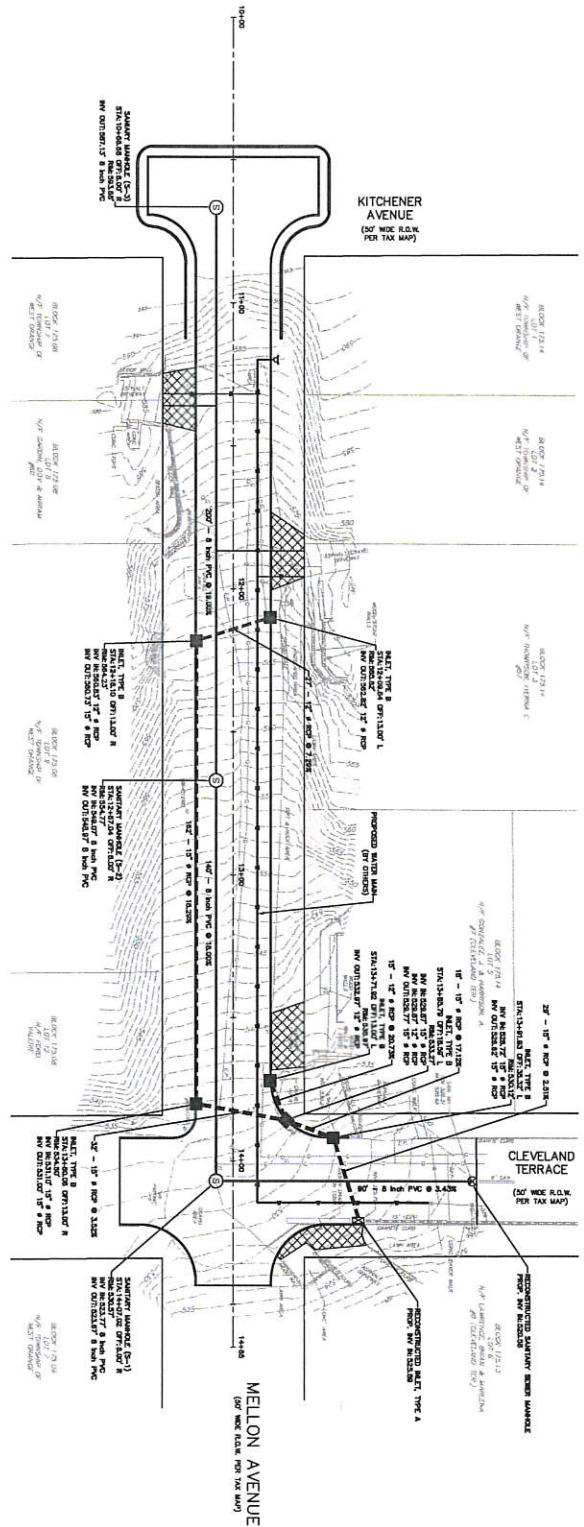

Exhibit "A"



PROJECT NO. 2021015
PHASE 1
SHEET NUMBER 7 OF 16
DRAWING NUMBER 7
DATE: 5/20/21
CHECKED BY: MAM
DRAWN BY: MAM
SCALE: 1"=20'

MUHAMMED ASSAL
 Professional Engineer
 License #25420
 1000 West Orange Avenue
 West Orange, NJ 07093

CLIENT: TOWNSHIP OF WEST ORANGE
 PROJECT: CONSTRUCTION PLANS FOR MELLON AVENUE IMPROVEMENTS PROJECT
 TOWNSHIP OF WEST ORANGE, ESSEX COUNTY, NEW JERSEY
 DRAWING TITLE: GRADING, DRAINAGE AND UTILITY PLAN

NO.	REVISIONS
1	
2	
3	
4	
5	
6	
7	

GPI Engineering
 1000 West Orange Avenue
 West Orange, NJ 07093
 Phone: 908.385.8800
 Fax: 908.385.8801
 Email: info@gpi-engineering.com